

HSS57

2-phase Hybrid Stepper Servo Driver

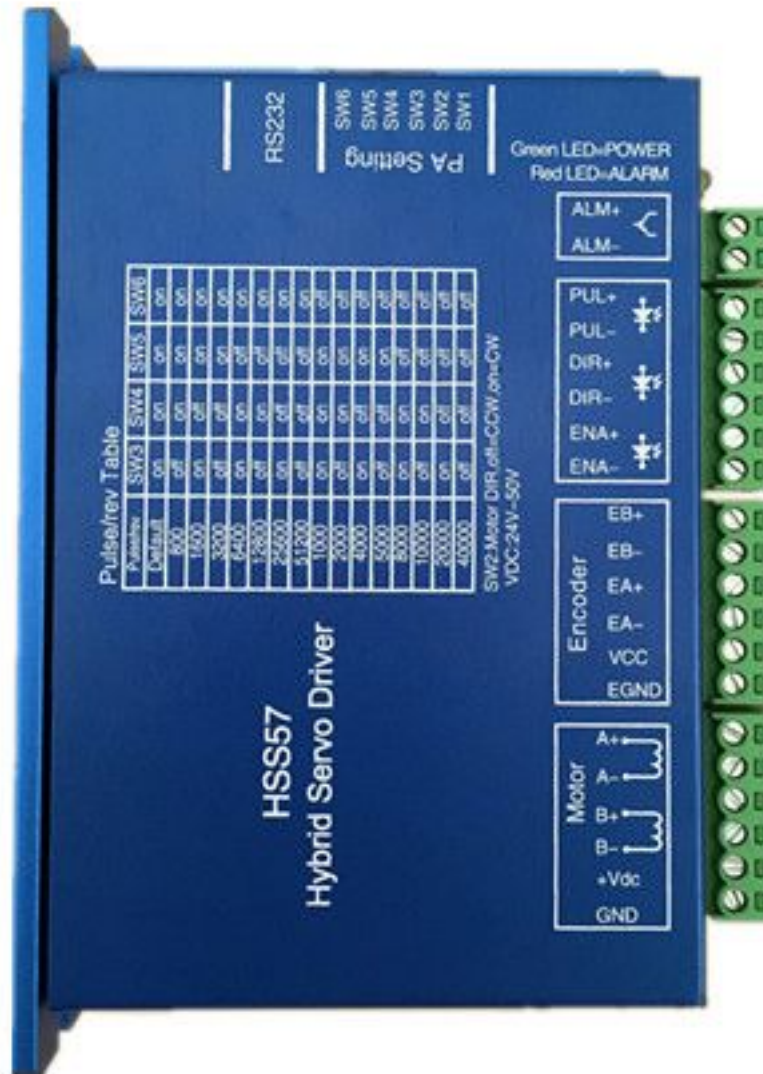

1. Instruction

1.1 Overview

HSS57 is 2 phase nema 23 series hybrid stepper servo driver. It adopts new generation 32 bit DSP and vector control technology, which can avoid the stepper motor losing steps and ensure the accuracy of the motor. The torque reducing is much lower than open loop stepper motor when it is at higher speed. The high speed performance and torque are enhanced in a great extent. Meanwhile the current control is based on the load, that can reduce the motor temperature rising effectively, then can extend the using life of the motor. The build-in place in position and alarm output signal can help the upper monitor to monitor and control. The function of position ultra difference alarm can ensure the machine work safely. The closed loop system is an ideal improvement and a good replacement of open loop system, Besides that, it also have some function of AC servo motors, but price is just half of AC servo.

1.2 Features

- 1.2.1 Stepper motor closed loop system, never lose step.
- 1.2.2 Improve motor output torque and working speed.
- 1.2.3 Automatic current adjustment based on load, lower temperature rising.
- 1.2.4 Suitable for all mechanical load conditions (include low rigidity belt pulley and wheel), no need to adjust gain parameter.
- 1.2.5 Motor work smoothly and low vibration, high dynamic performance at acceleration and deceleration.
- 1.2.6 No vibration from high speed to zero speed
- 1.2.7 Drive nema 23 series 2N.m closed loop stepper motor.
- 1.2.8 Pulses response frequency can reach 200KHZ
- 1.2.9 16 kinds microsteps choice, highest 51200microsteps/rev.
- 1.2.10 Voltage range: DC24V~50V
- 1.2.11 Over-current, over-voltage and position ultra difference protection function.

1.3 Applications

Closed loop stepper system can be applied to all kinds small automatic equipment and Instruments, such as engraving machine, special industrial sewing machine, stripping machine, marking machine, Dispensing machine, cutting machine, laser phototypesetting, graph plotter, NC machine, automatic, assembly equipment and so on.

2. Electrical, mechanical, environment Parameter

2.1 Electrical Parameter

Voltage range	DC24~50V
Peak current	Peak 6.0A (current change according to load)
Logic input current	7~20mA
frequency	0~200KHz
Suitable motor	57HSE2N
Encoder lines	1000
Insulation resistance	$\geq 500M\Omega$

2.2 Environment Parameter

Cooling method	Natural or radiator	
Operating environment	Operating Occasions	try to avoid dust, oil, corrosion gas
	Operating temprature	0~50°C
	Operating humidit	40~90%RH
	virbration	5.9m/s ² Max
Storage temperature	-20°C~65°C	
Weight	About 560g	

2.3 Installation Dimension

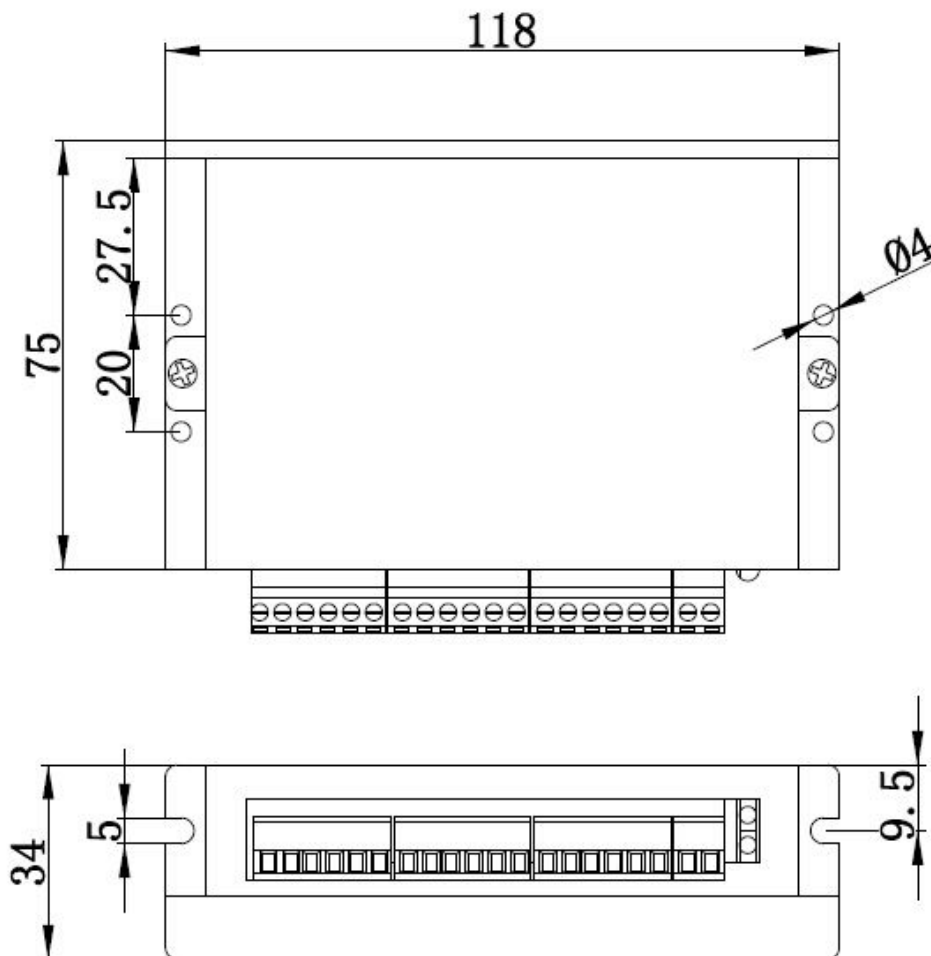

3. Driver connector, indicator and wiring diagram

3.1 motor and power supply input port

Port NO.			Motor Wire color
1	A+	A phase winding +	red
2	A-	A phase winding -	green
3	B+	B phase winding +	yellow
4	B-	B phase winding -	blue
5	+Vdc	Input voltage	DC24~50V
6	GND		

3.2. Encoder input port

Port NO.			Encoder Wire color
1	EB+	Encoder B phase input+	yellow
2	EB-	Encoder B phase input-	green
3	EA+	Encoder A phase input+	black
4	EA-	Encoder A phase input-	blue
5	VCC	Encoder voltage (+5V)	red
6	EGND	Encoder Grand (0V)	white

(The encoder wires misconnected will lead to the damage of driver or encoder.)

3.3. Signal controller port

Port NO.			
1	PUL+	Pulse input +	If the signal control voltage is +5V, then the signal control input port do not need to connect an extra resistance. If the signal control voltage is +12V, then the signal control input port need to connect to a 1K resistance. If the signal control voltage is +12V, then the signal control input port need to connect to a 2K resistance. OC output, there is alarm signal when closed, no alarm signal when open circuit.
2	PUL-	Pulse input -	
3	DIR+	Direction input +	
4	DIR-	Direction input -	
5	ENA+	Enable input +	
6	ENA-	Enable input -	
7	ALM+	Alarm signal output+	
8	ALM-	Alarm signal output-	

3.4. Switch setting

SW1: NC.

SW2: Rotate direction setting.on=CW, off=CCW.

SW3、SW4、SW5、SW6: Microstep setting

Micorstep/rev	SW3	SW4	SW5	SW6
Default (400)	on	on	on	on
800	off	on	on	on
1600	on	off	on	on
3200	off	off	on	on
6400	on	on	off	on
12800	off	on	off	on
25600	on	off	off	on
51200	off	off	off	on
1000	on	on	on	off
2000	off	on	on	off
4000	on	off	on	off
5000	off	off	on	off
8000	on	on	off	off
10000	off	on	off	off
20000	on	off	off	off
40000	off	off	off	off

3.5. Status indication

PWR: power indicator light : When power is on, the green light is on.

ALM: Alarm indicator light: If the red light is flicker one time within 3 seconds, that means over current or interphase short circuit; If the red light is flicker twice within 3 seconds, that means over voltage; if the red light is flicker three times within 3 seconds, that means position ultra difference or the encoder connector is disconnected.

3.6. Wire diagram

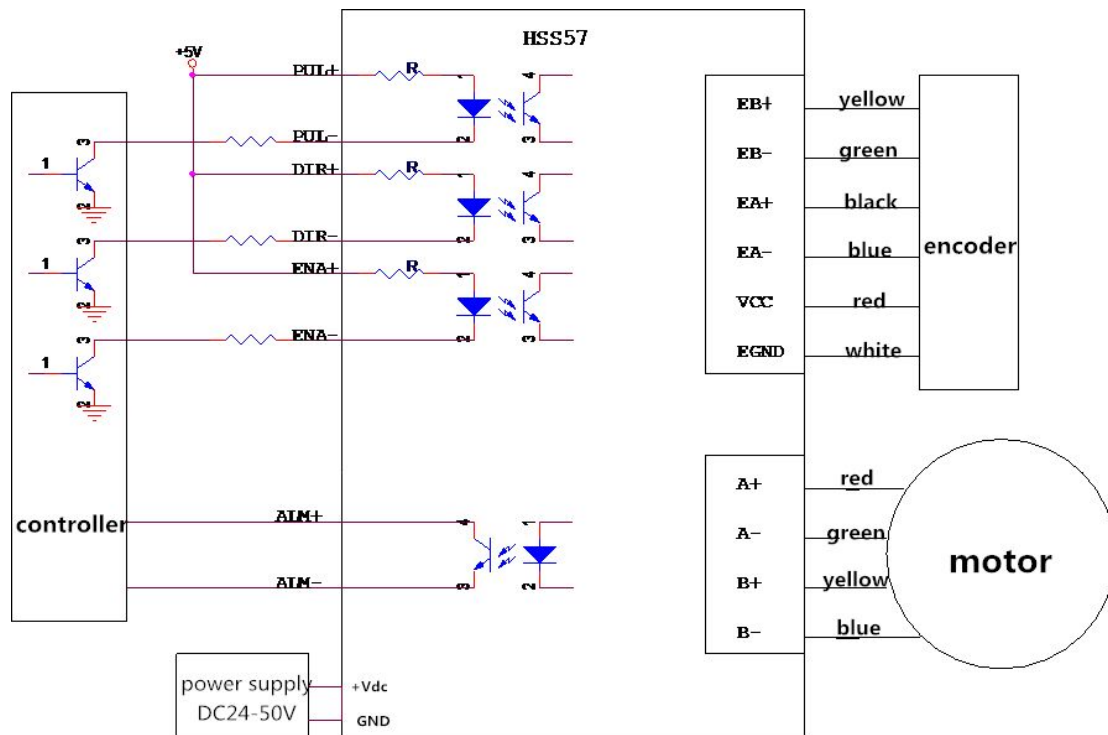

3.7. Wires for Encoder

Standard wire length for encoder is 2 meters. (Wire length can be customized.)